

EARTHING

Coupling for Unthreaded Copperbond Earth Rod

These Wallis couplings join lengths of unthreaded copperbond earth rods together so that rods can be deep driven and ensure continual contact through the coupling, during driving and after driving.

Wallis couplings have a high copper content ensuring excellent acid and corrosion resistance.

Rod Diameter	L	D	D1	Weight	Pack Qty	Part Number
12.7	68	19	21	0.07	25	ERBO 06
14.2	69	19	21	0.08	25	ERBO 07
17.2	79	24	27	0.14	25	ERBO 08

Material:

Aluminium Bronze.

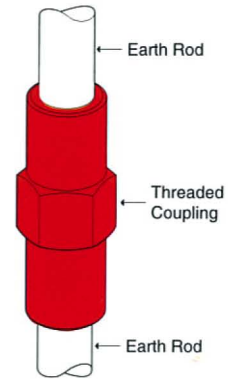
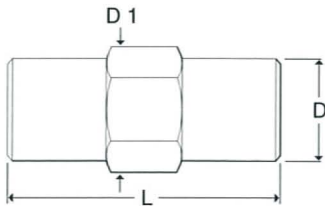

Driving Head for Unthreaded Copperbond Earth Rod

These reusable Wallis driving heads are suitable for driving earth rods by hand or by power hammer.

Rod Diameter	L	D	Weight	Pack Qty	Part Number
12.7	90	22	0.19	25	ERBD 06
14.2	100	22	0.22	25	ERBD 07
17.2	110	22	0.22	25	ERBD 08

Material:

High Tensile Steel.

